

# SĀVIRA

3.5 & 4.5 BHK LUXURY CONDOMINIUMS

## ELEVATING ELEGANCE





C O N T E N T



03

INTRODUCTION

04

AMENITIES

12

WHY CHOOSE  
SAVIRA?

13

LOCATION  
ADVANTAGES

14

FLOOR PLAN

15

SPECIFICATIONS

*\*Image used for illustrative purposes only*



---

SĀVIRA stands tall as a dream brought to life, an iconic tower inspired by Singapore's timeless charm where urban luxury dances with eco-conscious design, crafting a space where families can thrive in grandeur. This Boutique Luxury Condominium in Gurugram is a single tower with 3.5 & 4.5 BHK premium residences that tells a story of space reimagined, blending modernity with the warmth of home. With lush greens woven into its foundation and world-class amenities adorning its core.

SĀVIRA isn't just a solution to housing—  
it's the heart of a lifestyle waiting to unfold.

---



AMENITIES THAT  
MAKE EVERY DAY FEEL  
EXTRAORDINARY

ONE TOWER WITH  
EVERYTHING  
POSSIBLE





# 1 RECREATIONAL SPACES

These spaces can be your personal heaven, where you unwind, connect, and thrive. Whether it's a quiet corner to recharge, a vibrant spot for hobbies, or a lively setting to create cherished memories, SĀVIRA thoughtfully designed spaces that inspire you to embrace leisure with a touch of luxury.



\*Actual Render



\*Actual Render

SKY DECK



\*Actual Render



The Grand Hall /  
Party hall



Pre-event Space /  
Pre-functional Area



Open Terrace  
(1st F & 26th F)



HEALTH &  
FITNESS

At SĀVIRA health and recreation blend seamlessly with top-tier amenities. From refreshing swims in the pool to high-energy workouts at the gym, and friendly competitions in the Fun & Games lounge, every moment supports a life of wellness and joy.



\*Actual Render



\*Actual Render



\*Actual Render

YOGA DECK



Gymnasium



Fun & Games Lounge



Yoga Deck



Meditation Plaza



Herbal Garden



Jogging Track



Sunken Court



Serenity Pool



# SĀVIRA

## STRATEGIC CONNECTIVITY

Life at SĀVIRA is about making connections—whether it's for work, leisure, or wellness. With easy access to essential places like hospitals, restaurants, and banks, your daily journey is smoother, ensuring more time for what truly matters.



**ONE**  
GROUP  
THE ONE YOU CAN TRUST

\*Actual Render



\*Actual Render



\*Actual Render



Prime Location



Integrated Transportation



Future-proof Connectivity



4 LIFESTYLE ADDITIONS

Elevate your lifestyle with thoughtfully designed spaces that inspire connection, relaxation, and entertainment. Whether it's a serene escape, a cozy hub for conversations, or an open setting for unforgettable moments, every corner is crafted to enhance your everyday life.



\*Actual Render



\*Actual Render



\*Actual Render



Skyview Lounge



Community Café



Open-air Theatre



# SECURITY

Your safety is our priority, with advanced measures in place to ensure peace of mind. From secure access to constant vigilance and seamless communication, every layer is designed to provide unmatched security for you and for your loved ones.



\*Actual Render



\*Actual Render

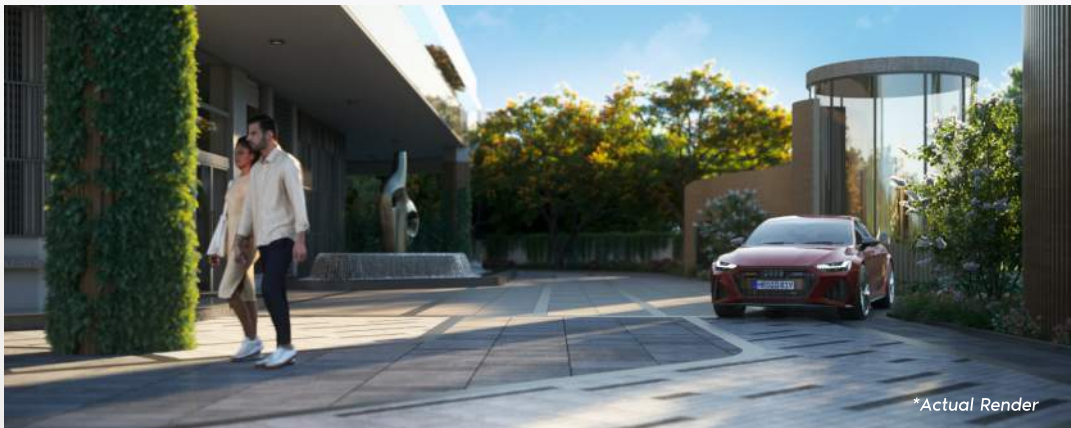

\*Actual Render

ENTRANCE GATE



Secure Biometric Door



24/7 Surveillance



4 Tier Security



PREMIUM  
AMENITIES

Experience the epitome of modern living with amenities that cater to every need. Whether it's hosting a barbecue under the stars, enjoying the panoramic views from the Skyview Lounge, or letting the little ones explore their creativity, there's something for everyone.



\*Actual Render



\*Actual Render



\*Actual Render

KIDS' PLAY AREA



Indoor & Outdoor  
Party Spaces



Skyview  
Lounge



Barbecue  
Terrace



Library



Kids' Play  
Area (1st F)



# 7 UTILITY

Utility begins the moment you arrive—no queues, no delays. Private lift access and four high-speed elevators ensure instant connectivity. Smart layouts, direct drop-offs, and planned circulation simplify everyday life.



\*Actual Render



Zero Waiting Time



4 High Speed Elevators  
(3 Private Elevators + 1 Service Elevator)



# Why CHOOSE SAVIRA?

A HOME LIKE NO OTHER



Centrally Located amidst Gurugram's  
finest neighborhoods



Perfect for families upgrading  
their lifestyle



Combines privacy, luxury,  
and modernity



# CONNECTED

## TO THE BEST OF GURUGRAM

SĀVIRA stands at the crossroads of elegance and convenience, offering you a home where every destination is within reach.





### 3.5 BHK





SPECIFICATIONS

LIVING / DINING AREAS							
FLOORING AC PROVISION WALLS CEILING	LIVING ROOM	MASTER BED ROOM	OTHER BED ROOMS	TOILET (MBR) & OTHER	KITCHEN	UTILITY ROOM & TOILET	BASEMENT
	: Imported marble	Laminate Wooden flooring	Laminate Wooden flooring	2x2 Tiles on floor	4x2 Tiles on floor	4x2 Tile in room & 2x2 Tile in toilet	VDF/Tremix flooring/ Floor Polishing
	: VRV	VRV	VRV	NA	Split Provision	Split Provision	NA
	: POP Punning - Emulsion paint	POP Punning - Emulsion paint	POP Punning - Emulsion paint	4x2 full wall height tiles	Tile - 2' above counter and behind chimney OBD	Utility Room - Acrylic Paint Toilet - 4x2 full height	Enamel till 5', then OBD
	: OBD	OBD	OBD	False ceiling	OBD	OBD	OBD

DOORS/WINDOWS			
MAIN ENTRANCE DOOR	INTERNAL/EXTERNAL DOORS	TOILET DOOR	WINDOWS
9 ft High Designer Door with Biometric	Internal Door - 2400 mm Laminated doors.  External door & window in UPVC/ Aluminium (Ext door three track)	2400 mm Laminated Doors	UPVC/ Aluminium with DGU Three track

OTHER SPECIFICATIONS					
KITCHEN COUNTER	KITCHEN STORAGE	SINK	TOILET	WASH BASIN AND COUNTER	WOODWORK
Engineered Stone / Granite	Moduler kitchen with under & over the counter cabinets, Hob & chimney.	SS doublebowl	European wall mounted WC in attached toilet. Fitting/ Fixture- High quality CP & sanitory fittings. Kohler, Grohe, Roca or Similar	Engineered Stone/Granite	Full height Modular Wardrobes

COMMON AREA			
CORRIDOR	COMMON STAIRCASE	BALCONY	
FLOORING : Vitrified Tiles PARAPET/RAILING : RCC parapet with dado in Granite min 1050mm height	Granite stone MS railing	Anti Skid Tiles Glass MS railing	

EXTERIOR				
FIRE FIGHTING SYSTEM	PLUMBING	ELECTRICAL	SECURITY SYSTEM	EXTERIOR FINISH
Sprinkler, Smoke detectors & alarm system as per norms	Corrosion proof CPVC piping for water supply inside bathroom & kitchen & UPVC pipes for stacks.	Fixtures & Fitting: Moduler switches, copper wiring, provision for celing fan an all bed room & ceiling light in kitchen, bathroom, balconys & passage.  Power Back-up: 100% for apartments & common areas.	Secured gate community with access control at entrances & CCTV for parking areas & entrance lobby at ground floor and other common areas.	Glazing with combination of stone, paint, Glass, Metal ets. Per the design recooended by the elevation design.



# SĀVIRA

By

